

The Webster V Serie oil pump is for high capacity of commercial, industrial and institutional heating application. This pump is also designed for use with heavy oil.

Pump are rated :

For single stage unit : up to 180 GPH with #2 fuel oil, to 270 GPH with 1000 SSU

For two-stage unit : up to 145 GPH with #2 fuel oil, to 205 GPH with 1000 SSU.

### COMPATIBILITY

#2 fuel oil and lighter ; fuel up to 1000 SSU.

### PUMP OPERATING PRINCIPLE

#### One pipe installation :

V pumps are not recommended for us in one pipe system..

#### Two pipe installation :

The steel plug of the inlet port ⑦ (see pump dimension) must be removed and the bypass plug must be inserted in the applicable inlet port allowing excess fuel is bypassed back to the tank. The return plug must not be reinstalled.

V serie pumps are shipped from the factory set for 2 pipe system.

#### Bleed :

Bleeding in two pipe operation is automatic for two-stage pump and most single stage pump. To bleed manually the system loosened pressure gauge port.

### PUMP IDENTIFICATION

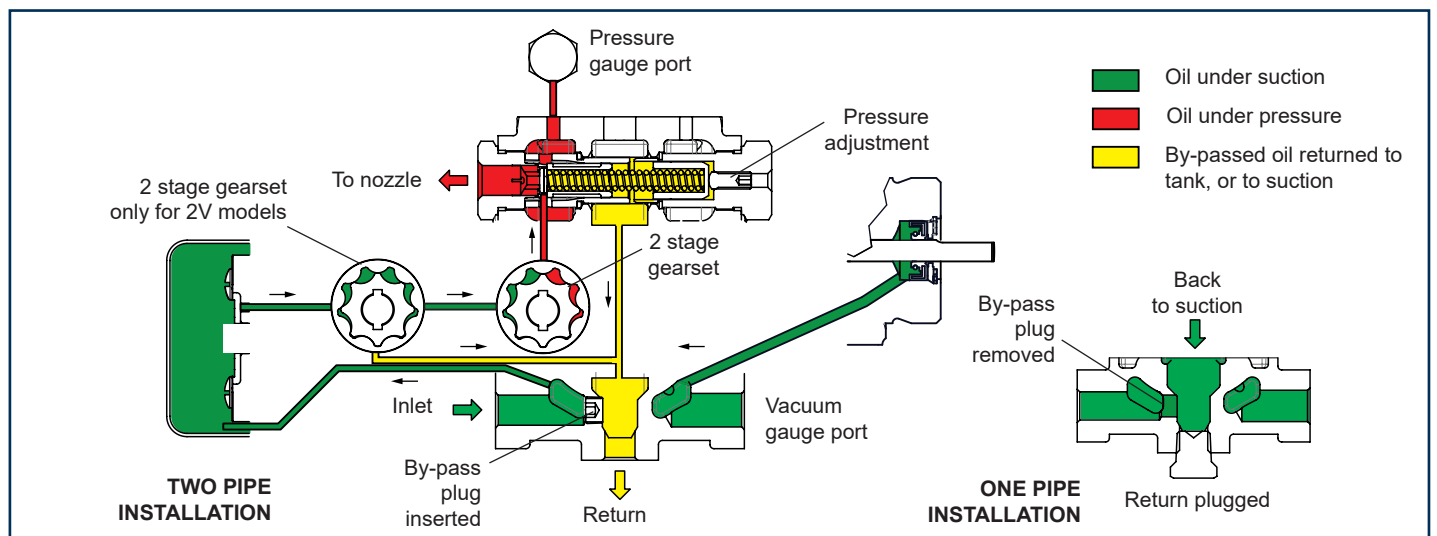
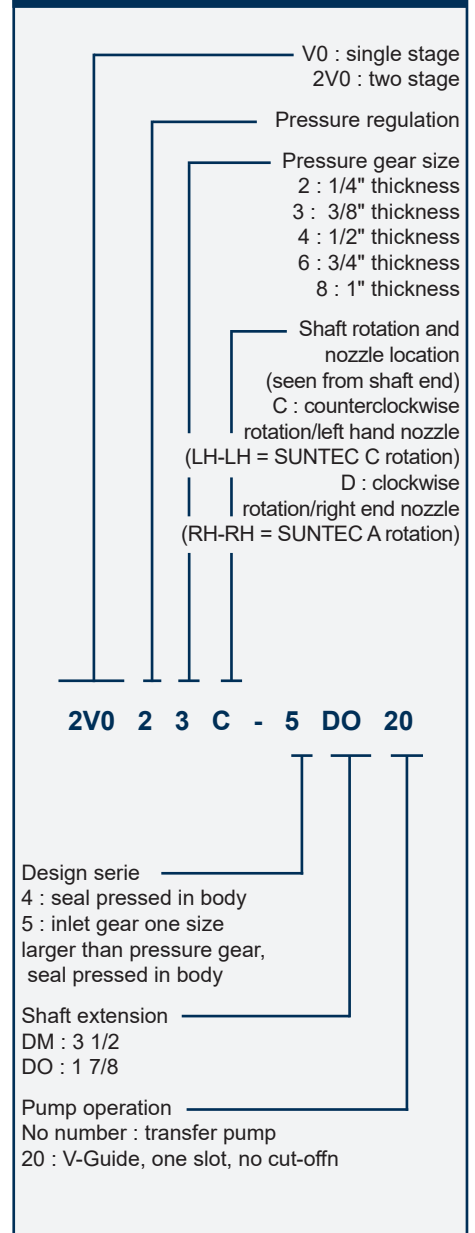

## TECHNICAL DATA

### General

Mounting	Flange mounting according to EN 225.
Connection threads	
Inlet in cover	1/2 NPTF
2 optional inlets	3/8 NPTF
Return	3/8 NPTF
Nozzle outlet	1/4 NPTF
Pressure gauge port	1/4 NPTF
Valve function	Pressure regulating
Shaft diameter	7/16" (Ø 0.4365 flat 0.396")
Shaft length	DM : 3,5" extension from mounting face DO : 1,88" extension from mounting face
Bypass plug	Inserted in applicable inlet port <b>2</b> for 2 pipe system; V pumps are not recommended for us in 1 pipe system.
Strainer open area	No internal filter external line filter recommended
Certified	

### Hydraulic data

Pressure range	0 : no internal pressure 2 : 125 - 330 PSI 5 : 85 - 120 PSI 8 : 15 -85 PSI	Delivery pressure setting 150 psi 100 psi 20 psi
Operating viscosity	34 to 1000 SSU	
Inlet and return pressures	10 psi max. <i>(NFPA limits pressures to 3psi max)</i>	
Suction height	Two-stage unit : 15" Hg max. vacuum Single stage unit : 10" Hg max. vacuum	
Torque (@45rpm)	4 in.lbs (gear size 2 ; 3 & 4) 6 in.lbs (gear size 6 & 8)	

### Variable X dimension

	X (in inch)
V002 / V003 / V004 / V006 / V022 / V023 / V024 / V026 / V052 / V056 / V086	5,13
V008 / V028	5,67
2V023 / 2V024	6,17
2V006 / 2V026 / 2V086	7,75

## PUMP DIMENSIONS (in inches)

Examples shows "D" rotation and nozzle outlet.

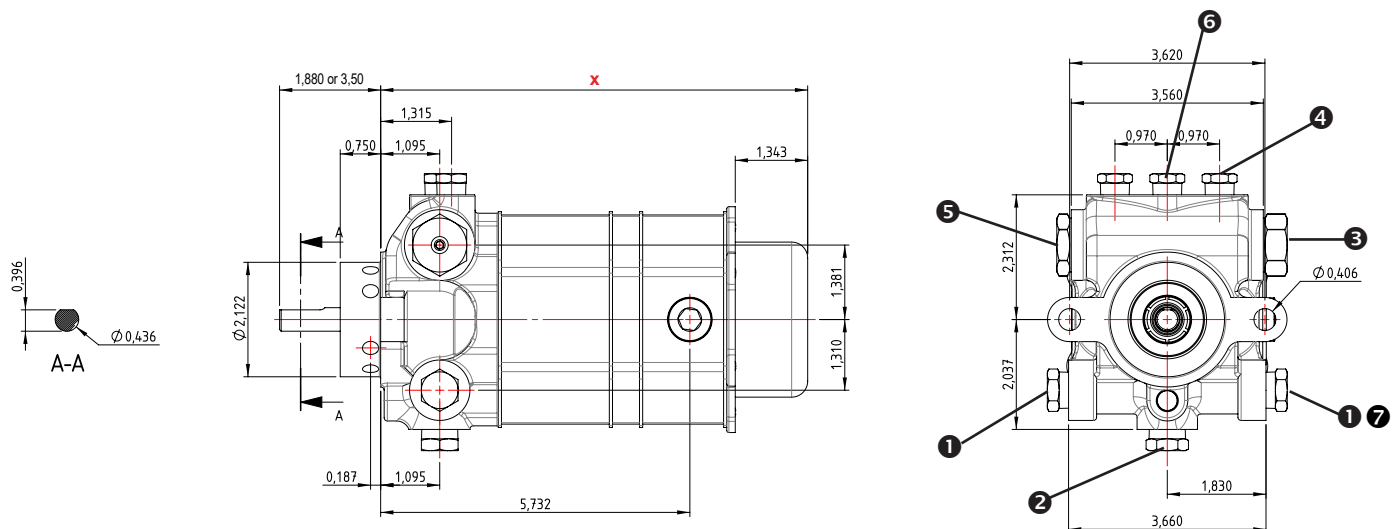

- 1** Inlet   **2** Return   **3** Nozzle outlet   **4** Pressure gauge port   **5** Pressure adjustment   **6** Optional return   **7** Inlet with bypass plug