

The Webster R Series oil pump is for medium capacity oil burner and are rated up to 80 GPH (at 100 PSI). It incorporates a pressure regulating valve and is available with or without cut-off function. One period featuring the unique Webster rotary self cleaning filter, simple flange or hub mounting, and an extended shaft length, the **R** series is adaptable to virtually every replacement.

### COMPATIBILITY

Fuel oil #2 and lighter.

### PUMP OPERATING PRINCIPLE

#### One pipe installation :

The bypass plug must not be installed. The excess fuel is returned back to the inlet.

#### Two pipe installation :

The steel plug of the inlet port  (see pump dimension) must be removed and the bypass plug must be inserted in the applicable inlet port allowing excess fuel is bypassed back to the tank. The return plug must not be reinstalled.

Two-pipe operation is recommended for all high capacity units.

#### Bleed :

Bleeding in two pipe operation is automatic for two-stage pump, but it may be accelerated by opening the easy flow bleeder or loosening pressure gauge port. If single stage or pump with 1/8 NPTF nozzle outlet (pump code ends by 3 or 4) bleed all air from the system by opening bleeder valve or loosening pressure gauge port.

In one pipe operation, the easy flow bleeder valve or pressure gauge port must be loosened to bleed the system.

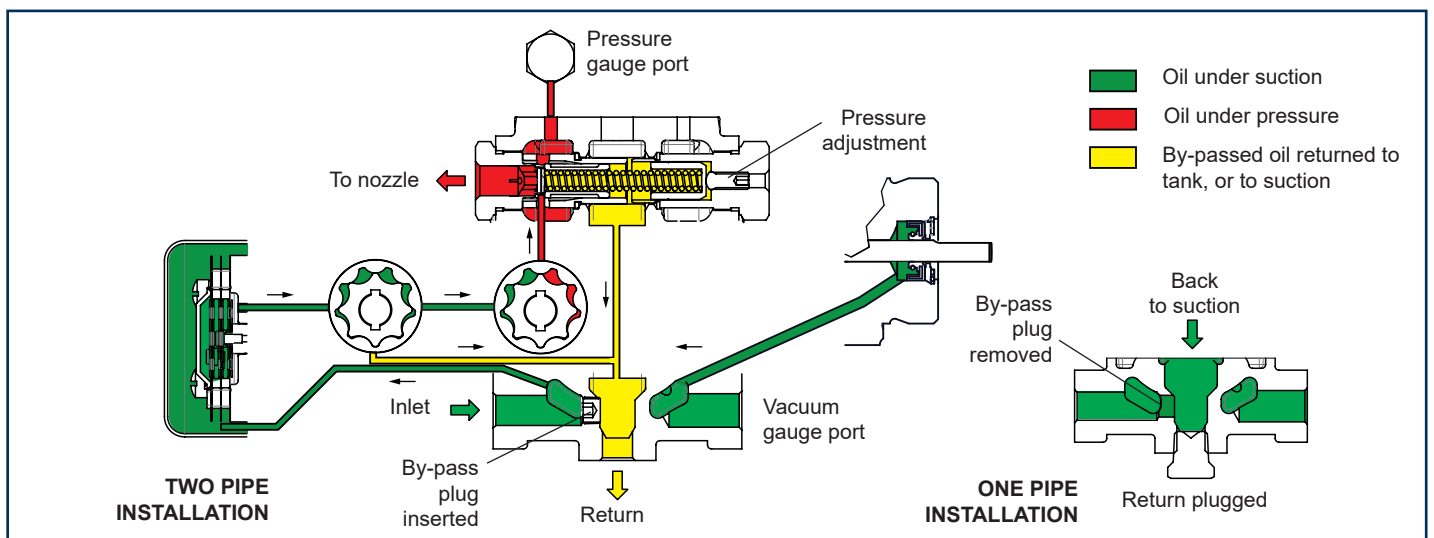
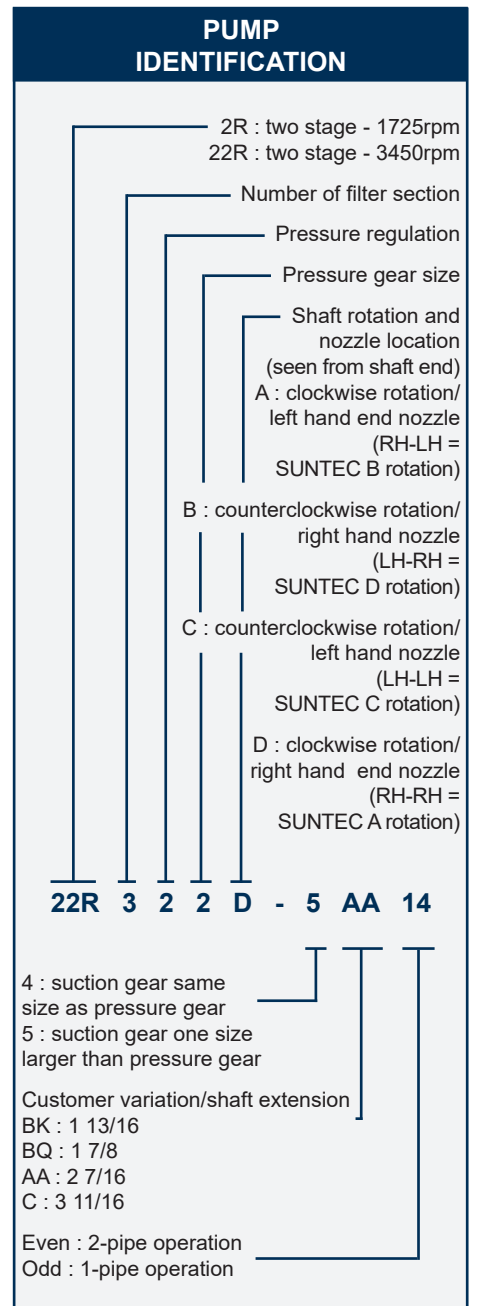

## TECHNICAL DATA

### General

Mounting	Flange mounting according to EN 225. Hub with slot for hub mounting.
Connection threads	
Inlet and return	1/4 NPTF
Nozzle outlet	Pump ending in 3 or 4 : 1/8 NPTF Pump ending in 13 or 14 : 1/4 NPTF
Pressure gauge port	1/4 NPTF
Valve function	Pressure regulating and cut-off (except model ending by 13 or 14)
Shaft	7/16" (Ø 0.4365 flat 0.396")
Bypass plug	Inserted in applicable inlet port (7) for 2 pipe system; to be removed with a 3/16" Allen key for 1 pipe system.

Certified



### Hydraulic data

Pressure range	Max pressure	Delivery pressure setting
	1 : 150 PSI	100 PSI
	2 : 300 PSI	100 PSI
	3 : 20 PSI	10 PSI
	4 : 45 PSI	40 PSI
	5 : 100 PSI	100 PSI
	6 : 125 PSI	100 PSI
	8 : 80 PSI	20 PSI

Inlet and return pressures 10 psi max.  
*NFPA limits pressures to 3psi max*

Suction height Two-stage unit : 15" Hg max. vacuum  
Single stage unit : 10" Hg max. vacuum

Torque (@45rpm) 4 in.lbs (gear size 0; 1; 2 & 3)  
6 in.lbs (gear size 6 & 8)

### Variable X dimension

	X (in inch)
22R211 / 22R220 / 22R221 / 22R250	3,75
2R213 / 2R223 / 2R233 / 2R253 / 2R283 / 22R322	4,25
22R613 / 22R623	4,75
2R616 / 2R618 / 2R626 / 2R628 / 2R636 / 2R656 / 2R686	5,75

### PUMP DIMENSIONS (in inches)

Examples shows "D" rotation and nozzle outlet.

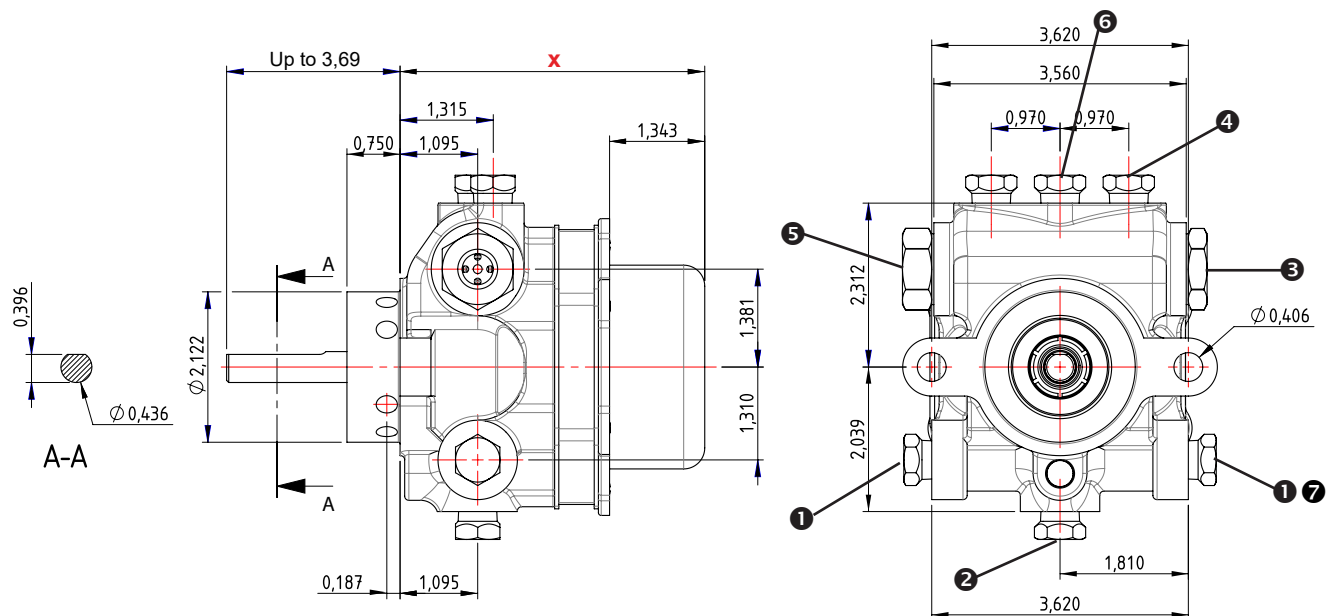

1 Inlet 2 Return 3 Nozzle outlet 4 Pressure gauge port 5 Pressure adjustment 6 Optional return 7 Inlet with bypass plug