

# Fuel Transfer Unit

## FTU J4 / E4 / J6 / E6

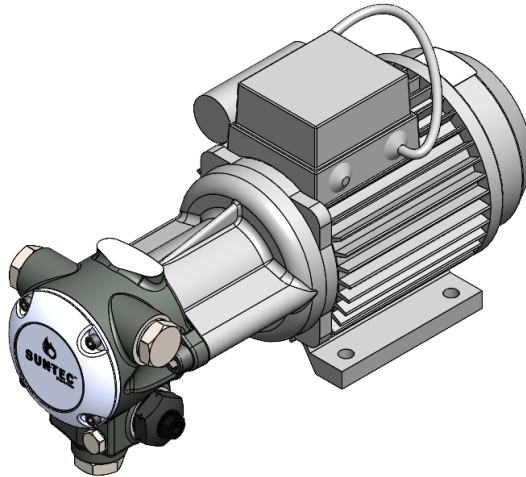

### FTU Capacity

- Rated speed: 2850 rpm
- Viscosity: 5 cSt

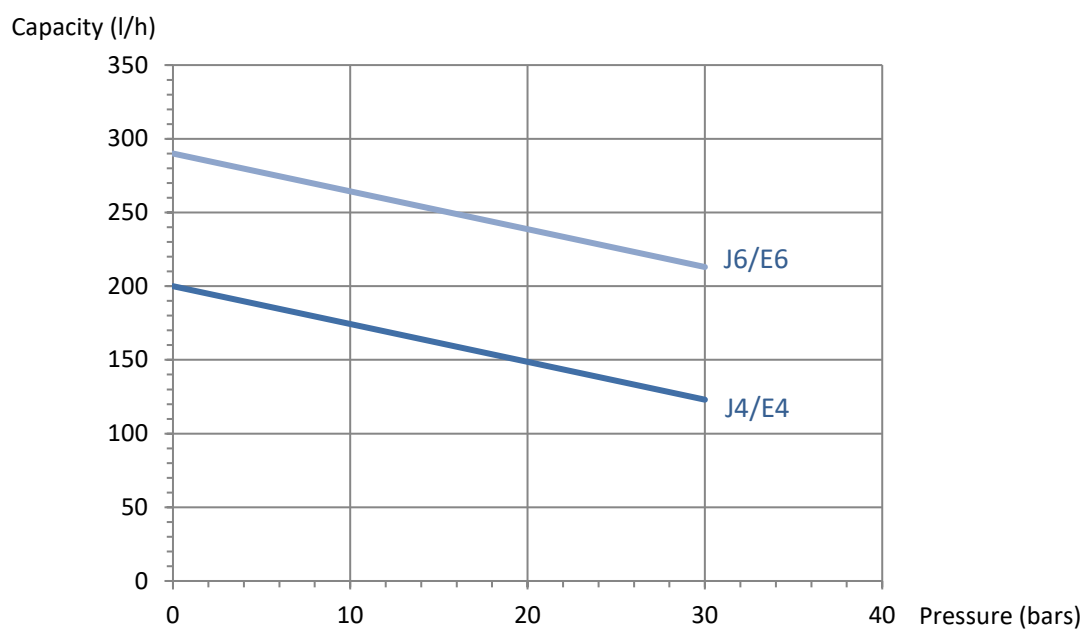

## Technical Data

### ● General

- Application: Medium & light oil, HVO, B100  
E pumps also compatible with heavy oil (for kerosene applications, contact SUNTEC)
- Installation: Two-pipe system
- Connection threads : Cylindrical according to ISO 228/1
- Inlet and return: G 1/2
- Nozzle outlet: G 1/4
- Pressure gauge port: G 1/8
- Vacuum gauge port: G 1/2
- Noise level: FTU J4/E4/J6/E6 < 55 dBA
- Voltage: 230-400V – 50 Hz
- Power: 550W
- Phase: Single or three-phase

### ● Hydraulic Data

#### J pump

- Operating viscosity : 2 - 75 mm<sup>2</sup>/s (cSt)
- Inlet pressure : 1,5 bars max
  
- Oil temperature : 0 - 90°C in the Pump

#### E pump

- Operating viscosity : 3 - 75 mm<sup>2</sup>/s (cSt)
- Light oil : 0,45 bars max. vacuum to prevent air separation from oil
- Heavy oil : 3,5 bars max.
- Oil temperature : 0 - 130°C in the Pump

## Dimensions

(Example)

