

# Fuel Transfer Unit

## FTU E4 / E6 / E7

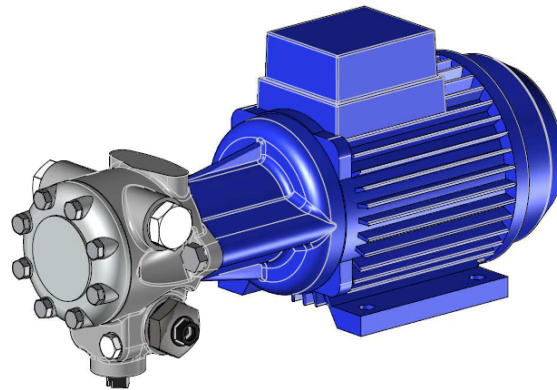

### FTU Capacity

- Rated speed: 1425 rpm
- Viscosity: 5 cSt

- Rated speed: 2850 rpm
- Viscosity: 5 cSt

Capacity (l/h)

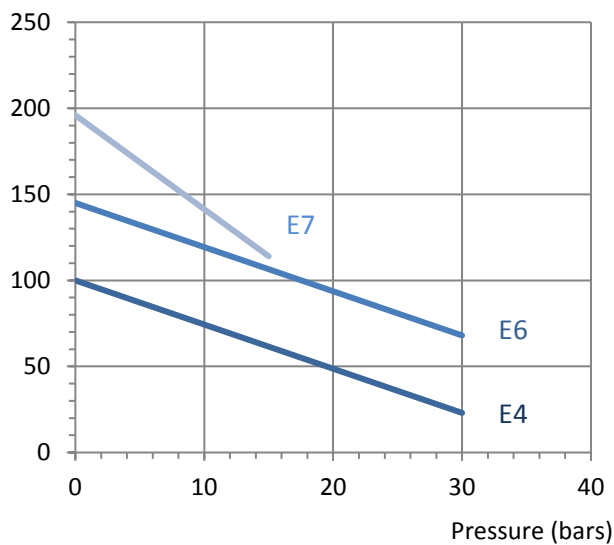

Capacity (l/h)

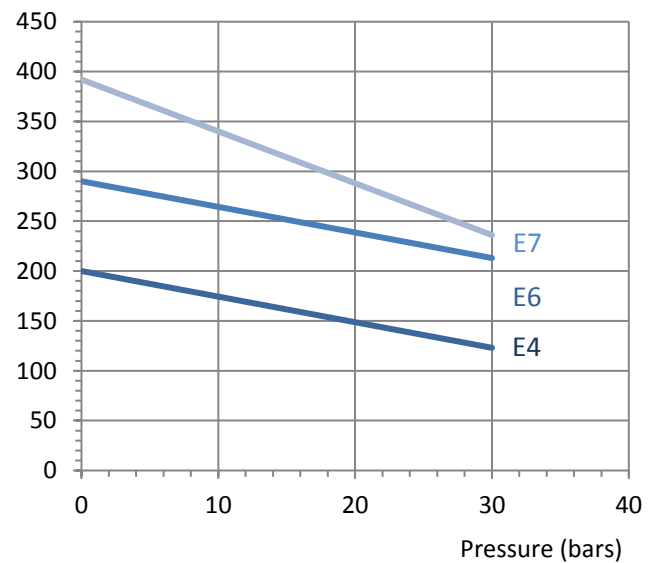

## Technical Data

### ● General

- Application: Light oil, B10 and heavy oil  
(for kerosene applications, contact SUNTEC)
- Installation: Two-pipe system
- Connection threads : Cylindrical according to ISO 228/1
- Inlet and return: G 1/2
- Nozzle outlet: G 1/4
- Pressure gauge port: G 1/8
- Vacuum gauge port: G 1/2
- Noise level: FTU E4/E6 < 55 dBA  
(@ 2850 rpm & 20 bars) FTU E7 < 60 dBA
- Voltage: 230-400V – 50 Hz

### ● Hydraulic Data

- Pressure range: 1,4 - 2,8 bars or 2,8 - 5,6 bars or 14 - 30 bars
- Operating viscosity: 3 - 75 mm<sup>2</sup>/s (cSt)
- Inlet pressure: Light oil: 0,45 bars max. vacuum to prevent  
air separation from oil  
Heavy oil: 3,5 bars max.
- Oil temperature: 0 - 130°C in the Pump

## Dimensions

(Example)

